

# Information Sheet

## Primer Flush Kits



*NOTE: Not compatible with 300 Series Liquid Ends.*

**Kit No. 26220 for  
.375" O.D. Tubing**

**Kit No. 26221 for  
.5" O.D. Tubing/L.E. 70 & 80 Series**

**Kit No. 26708 for  
.5" O.D. Tubing/L.E. 20 & 30 Series**

- For priming and/or flushing pump liquid end
- Easy field installation
- Polypropylene & ultra-high molecular weight polyethylene construction

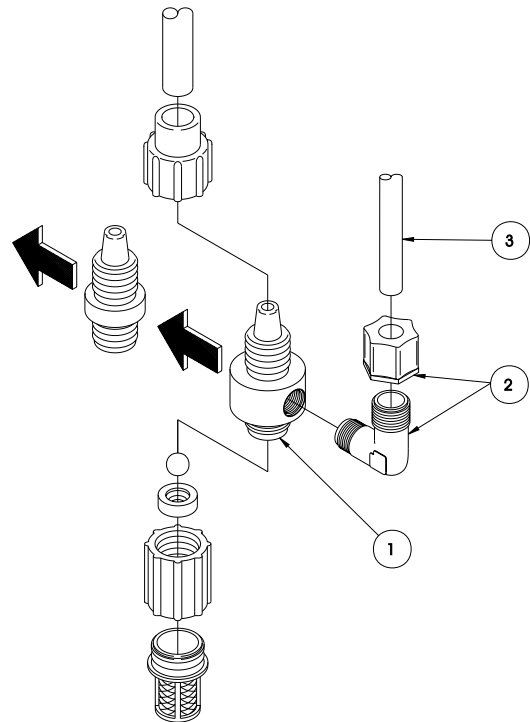

### PRIMING

By equalizing the pressure on the suction and discharge sides of the pump head, the need to disconnect tubing to bleed air from the pump is eliminated. Pump priming is reduced to the opening of a valve.

### FLUSHING

For solutions which have a tendency to clog valves by congealing or settling, the primer flush kit makes it easy to flush the liquid end whenever the pump is to be shut down.

Or, with the addition of a small solenoid valve and repeat cycle timer (for example, an LMI Remote Auto-Flush Controller), an LMI pump can be equipped so that it is automatically flushed at certain intervals.

Ref. No.	Part No.	Description	Quantity		
			Kit No. 26220	Kit No. 26221	Kit No. 26708
1	26029	Flush Valve Body, 0.375" O.D. Tubing	1	0	0
	25199	Flush Valve Body for 0.5" O.D. Tubing & 0.375" Valve Ball	0	1	0
	25605	Flush Valve Body for 0.5" O.D. Tubing & 0.5" Valve Ball	0	0	1
2	10834	Elbow Connector Assembly	1	1	1
3	10342-16	Tubing, Polyethylene, 16 ft (4.9 m)	1	1	1



8 Post Office Square  
Acton, MA 01720 USA  
TEL: (978) 263-9800  
FAX: (978) 264-9172  
<http://www.lmipumps.com>



# TYPICAL INSTALLATION

**NOTE:** Flush line connection to fresh water supply should be at least 5 psi (0.34 Bar) higher than injection point.

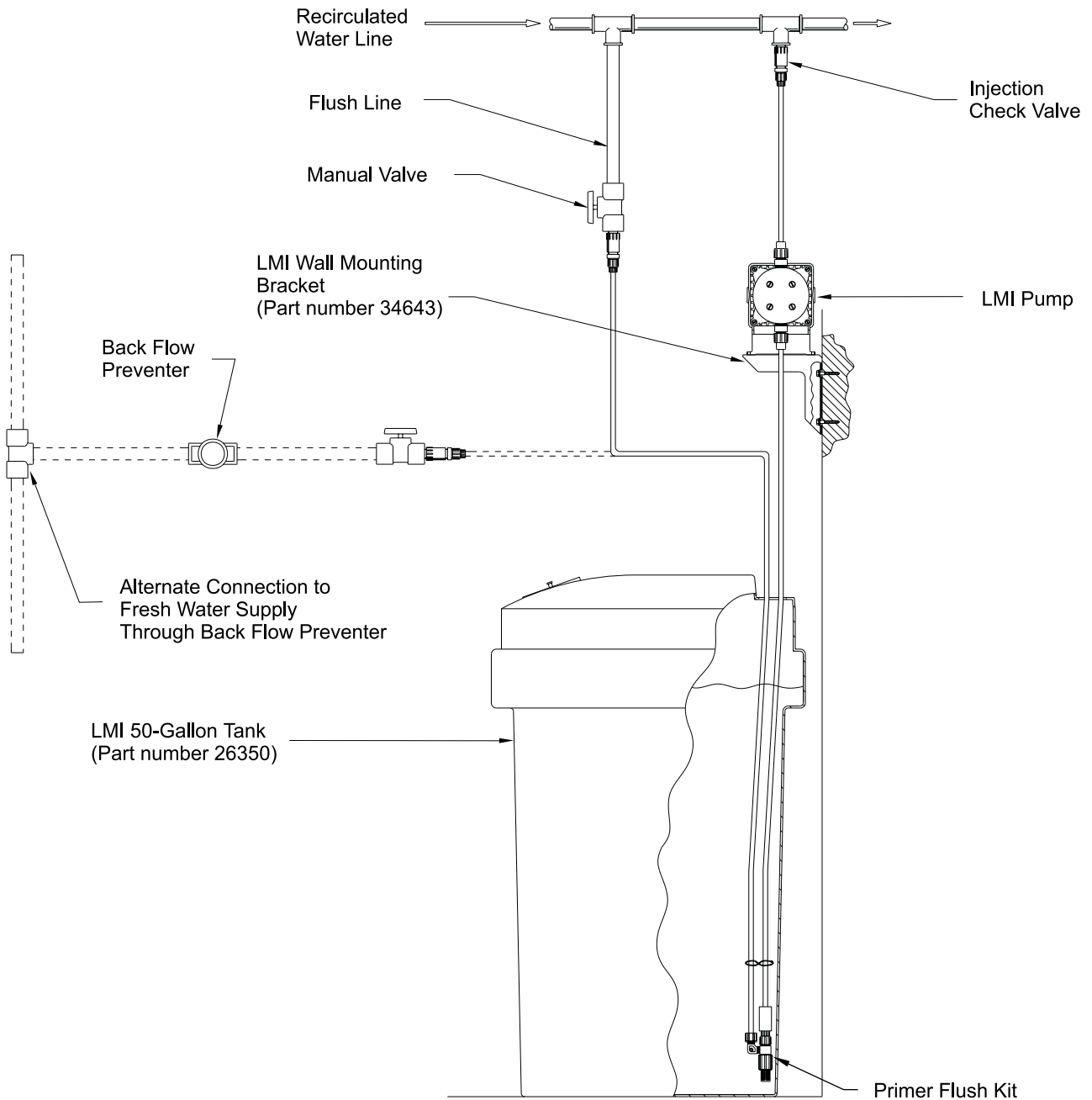

## Primer Flush Connection