

J.L. WINGERT CO.

P.O. Box 6207 • Garden Grove, CA 92846-6207 / 11800 Monarch Street • Garden Grove, CA 92841-2113
 Phone (714) 379-5519 • Fax (714) 379-5549 ■ Email: customerservice@jllwingert.com
 Northern California Region • Phone (510) 487-5310 ■ Southwest Region • Phone (602) 470-1015
 www.jllwingert.com

MANUFACTURING: Mixers, Bypass Feeders, Filter Feeders, Bromine Feeders, Sample Coolers, Sludge Traps, Separators, Separator Systems, Tank Stands,
 Tank Package Systems, Glycol Feed Systems, Coupon Racks, Control Stations, NEMA Enclosures, Custom Packaged Systems and Specialty Welding

Instruction Sheet #0323 Rev. "E" (07/04)

VALVE PACKAGE INSTRUCTION SHEET

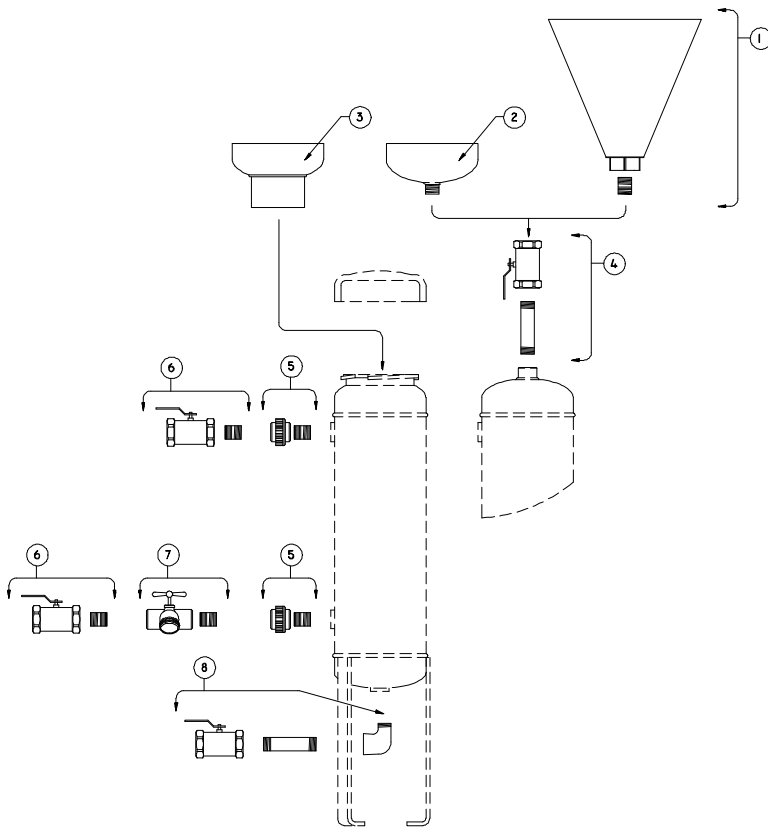

GENERAL NOTES

KEY	PART NUMBER	DESCRIPTION
1	3069P	PE FUNNEL: 10" diameter polyethylene fill funnel
2	3069	FUNNEL: 6" diameter carbon steel fill funnel
3	3218	FUNNEL: 6" diameter carbon steel fill funnel with spill guard
4	3142	FILL VALVE: 1" NPT 300PSI brass ball valve and 5" black nipple
5	3079	UNION VALVE: 3/4" NPT 300 PSI black union valve and installation nipple
6	3141	ISOLATION VALVE: 3/4" NPT 300 PSI brass ball valve and installation nipple
7	3063	HOSE BIBB: 3/4" NPT 300 PSI hose bibb with installation tee and nipple
8	3143	DRAIN VALVE: 3/4" NPT 300 PSI brass ball valve with installation street ell and nipple

VALVE PACKAGES

PART NUMBER	DESCRIPTION	INCLUDES KEY NUMBERS
3138	Flat bottom valve package	(2) #5 (2) #6 (1) #7
3138F	Flat bottom valve package with fill funnel	(1) #3 (2) #5 (2) #6 (1) #7
3139	Dome bottom valve package	(2) #5 (2) #6 (1) #8
3139F	Dome bottom valve package with fill funnel	(1) #3 (2) #5 (2) #6 (1) #8
3140	High pressure valve package with steel funnel	(1) #2 (1) #4 (2) #5 (2) #6 (1) #8
3140P	High pressure valve package with PE funnel	(1) #1 (1) #4 (2) #5 (2) #6 (1) #8

UNPACKING:

- 1) Ensure that there has been no damage in shipping. If any damage has occurred, please notify the carrier and the J.L. Wingert Co. immediately.

INSTALLATION:

- 1) Assemble valves and fittings as shown on the diagram above.
- 2) Wingert Bypass Feeders and Pleated Filter Feeders should be installed with the inlet at the lower side entry. Wingert Filter Feeders should be installed with the inlet at the upper side fitting.

The J.L. Wingert Co. offers a full line of feeder installation fittings such as sight flow indicators, air release valves, and filter bag kits. See our product brochure or call our customer service department for help with your application.

All dimensions are subject to change without notice.